

Dry Floor Constructions

**Data Sheet 4A
Timber Suspended - From Above**

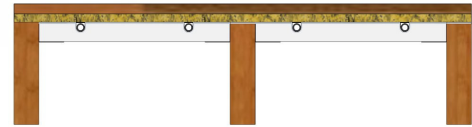
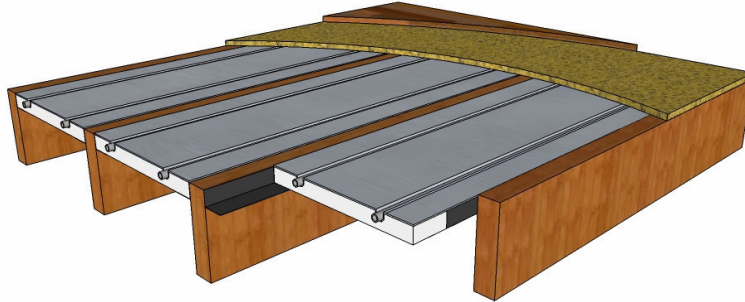

Timber Suspended Floors

Timber suspended floor systems include both joisted floors with conventional joists supported on sleeper walls as well as solid floors with timber battens fixed or loose laid to the floor.

The USL modular diffuser panel floor system is fixed from above and consists of CNC routed high performance polystyrene panels. The panels are then inlaid with aluminium diffusion plates across the full width of the panel.

End panels are routed with the correct minimum bend radius to ensure the Polybutylene pipe is located firmly and accurately at the correct radius this will ensure that any potential risk of damage to the underfloor pipework from possible kinks is eliminated.

The polystyrene diffuser modules are available in:

- 340mm x 2400mm wide Modules
- 540mm x 2400mm wide Modules
- 35mm, 50mm or 75mm thick Modules

Pipe centres are available in:

- 200mm centres
- 300mm centres

The diffuser panels are held in place with either an “L” shaped angle bracket or timber battens that when installed provide support for the panel and ensures full contact with diffusion plate modules and the floor deck at all times.

USL Polybutylene pipework is then pressed into the diffusion plates which act as an excellent heat conductor. With the floor deck installed the heat spreads across the underside of the floor deck resulting in an efficient underfloor heating system.